

# GBC version 2, Shut-off ball valve for R744 (CO<sub>2</sub>) low pressure

Danfoss shut-off ball valves, type GBC v2 for CO<sub>2</sub> are manually operated shut-off valves only for single-flow direction. The valves are approved for applications in liquid, suction and hot-gas lines in refrigeration and air conditioning systems. The valves offer maximum tightness across the seat/seal with minimum pressure drop.

These ball valves give maximum flow in the fully open position. They are designed for operation within a broad temperature range. The valves are equipped with a one-piece seal cap to prevent tampering.

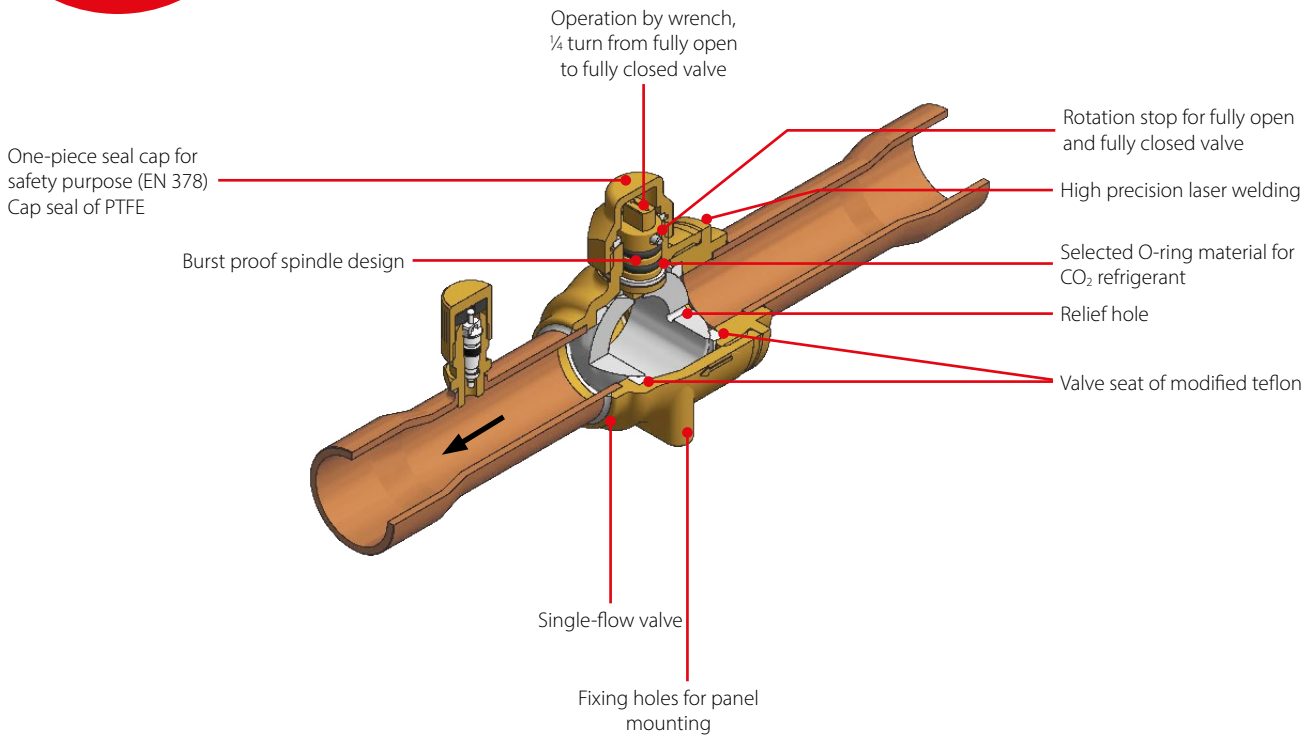

## Facts

### Application:

- The valves can be used for applications in liquid, suction and hot-gas lines in refrigeration and air-conditioning systems
- Applicable to R744 (CO<sub>2</sub>)
- Slimline body - easier to install and service
- 1/4 turn from fully open to fully closed
- Rotation stops at fully open and fully closed positions
- Indicator on spindle top shows degree of opening
- Precision laser welded construction
- Burst-proof spindle design
- Valve seal of low friction, tight-sealing modified PTFE Teflon®
- Double O-ring stem seal design
- Selected O-ring material for CO<sub>2</sub> refrigerant
- Customized brass material ensures consistent performance under aggressive environment
- Drilled and tapped for panel mounting
- Relief hole design to release entrapped liquid
- Media temperature range: -40 – 100 °C / -40 – 212 °F
- Max. working pressure (PS / MWP): 45 bar / 650 psig
- Flow direction: Single-flow
- Approval: C UL US LISTED, EAC, CE

# Technical data and ordering



## GBC v2 without access port, solder ODF / ODF

### Ordering

Type	Solder ODF / ODF connection		Max. working pressure PS / MWP		K <sub>v</sub> value <sup>1)</sup> [m <sup>3</sup> /h]	C <sub>v</sub> value <sup>1)</sup> [gal/min]	Code no.
	[in]	[mm]	[bar]	[psig]			
GBC 6s	–	6	45	650	1.74	2.01	009L7570
GBC 6s	¼	–	45	650	1.74	2.01	009L7520
GBC 10s	–	10	45	650	7.52	8.69	009L7571
GBC 10s	¾	–	45	650	7.52	8.69	009L7521
GBC 12s	–	12	45	650	12.9	14.9	009L7572
GBC 12s	½	–	45	650	12.9	14.9	009L7522
GBC 16s	⅝	16	45	650	15.7	18.1	009L7523
GBC 18s	–	18	45	650	21.9	25.4	009L7574
GBC 18s	¾	–	45	650	21.9	25.4	009L7524
GBC 22s	⅞	22	45	650	33.3	38.5	009L7525
GBC 28s	–	28	45	650	62	71	009L7576
GBC 28s	1 ½	–	45	650	62	71	009L7526
GBC 35s	1 ⅜	35	45	650	92	107	009L7528
GBC 42s	–	42	45	650	134	155	009L7579
GBC 42s	1 ⅝	–	45	650	134	155	009L7529

<sup>1)</sup> calculated based on fluid dynamic equations

## GBC v2 with access port, solder ODF / ODF

### Ordering



Type	Solder ODF / ODF connection		K <sub>v</sub> value <sup>1)</sup> [m <sup>3</sup> /h]	C <sub>v</sub> value <sup>1)</sup> [gal/min]	Code no.
	[in]	[mm]			
GBC 6s	¼	–	1.74	2.01	009L7553
GBC 6s	–	6	1.74	2.01	009L7554
GBC 10s	¾	–	7.52	8.69	009L7555
GBC 10s	–	10	7.52	8.69	009L7556
GBC 12s	½	–	12.92	14.94	009L7557
GBC 12s	–	12	12.92	14.94	009L7558
GBC 16s	⅝	16	15.66	18.1	009L7534
GBC 18s	¾	–	21.93	25.35	009L7563
GBC 18s	–	18	21.93	25.35	009L7564
GBC 22s	⅞	22	33.34	38.54	009L7536
GBC 28s	1 ½	–	62.25	71.96	009L7565
GBC 28s	–	28	62.25	71.96	009L7566
GBC 35s	1 ⅜	35	92.76	107.23	009L7567
GBC 42s	1 ⅝	–	134.76	155.78	009L7568
GBC 42s	–	42	134.76	155.78	009L7569

<sup>1)</sup> calculated based on fluid dynamic equations

## Spare parts - Seal cap kit

### Ordering



Type	Valve connection size		Industrial pack	Code no.
	[in]	[mm]		
GBC 6s - GBC 22s	¼ – ⅞	6 – 22	6	009L7210
GBC 28s - GBC 35s	1 ½ – 1 ⅜	28 – 35	4	009L7211
GBC 42s	1 ⅝	42	4	009L7212

## Spare parts - Bracket kit

### Ordering

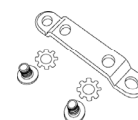

Type	Valve connection size		Industrial pack	Code no.
	[in]	[mm]		
GBC 6s - GBC 16s	¼ – ⅝	6 – 16	12	009G7084
GBC 18s - GBC 22s	¾ – ⅞	18 – 22	12	009G7085
GBC 28s	1 ½	28	10	009G7086
GBC 35s	1 ⅜	35	5	009G7087
GBC 42s	1 ⅝	42	4	009G7088